

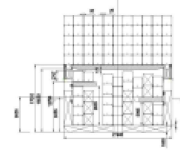

**Super A
Class**

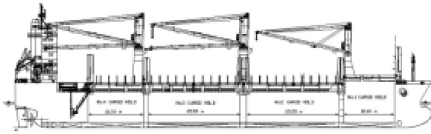

Ship Basic Information

Builders	Shandong Huanghai Shipyard, Shidao, China
Type	Double Hull Box-shaped Multi Purpose Tweendeck/Container Carrier
Flag	Cyprus, Liberia
Port of registry	Limassol, Monrovia
Classification	GL + 100 A5, E1, G, strengthened for heavy cargoes, equipped for carriage of containers, IW, + MC E1 AUT. SOLAS II-2 Reg.19 Dangerous goods cl. 1.4s, 2, 3, 4, 5.1, 6.1, 8, 9

Vessel Specific Information

	IMO No	Year of Built	Flag	Summer Deadweight (mt)	Lightweight (mt)
SEABOARD VALPARAISO	9393539	2009	Cyprus	25,820.3	9,290
AAL GENOA	9393553	2010	Liberia	25,733.4	9,377
SEABOARD PERU	9393577	2010	Cyprus	25,820.5	9,290.5
SEABOARD AMERICA	9393589	2010	Cyprus	25,747.4	9,290

Dimension and Main Data

Length o. a.	159.99 m
Length b.p.	152.00 m
Breadth max.	27.85 m
Depth to maindeck	13.50 m
Deadweight summer	25,000 mt
Scantling draft	9.80 m
Design draft	8.50 m
Draft summer	9.50 m
Speed	abt 16.0 kn @ 29.0 mt IFO 380 plus 2 mt IFO 380 for aux eng (Bf 2), on design draft
ST.LAWRENCE	NO
BOWTHRUSTER	YES
CEMENT HOLE FITTED	YES (900mm Diameter)
GT	19,128
NT	9,736
Crew Complement	28

Tank Capacity (including day and settling tanks)

Fuel HFO 380	1,455 cbm (at 100 %)
MDO	156 cbm (at 100 %)
Freshwater	239 cbm
Waterballast	9,741 cbm
Hatchcovers	Original MacGregor Finland hydr folding, non-sequential hatch cover openings
Number of holds, Hatches	4 holds, 4 hatches configurable to 6 holds / 6 hatches
Hold dimensions(LxBxH)	No. 1: 19.75 m x 18.00 m
	No. 2: 35.55 m x 23.00 m
	No. 3: 35.55 m x 23.00 m
	No. 4: 21.33 m x 23.00 m
Hatch dimensions	No. 1: 18.96 m x 18.00 m
	No. 2: 33.58 m x 23.00 m
	No. 3: 33.58 m x 23.00 m
	No. 4: 16.79 m x 23.00 m
	No. 5: 16.79 m x 23.00 m
	No. 6: 21.33 m x 23.00 m

All holds mechanically ventilated / 6 air changes per hour

	Capacity (cbf)	Grain	Bale
No. 1		207,747	207,747
No. 2		409,279	409,279
No. 3		409,279	409,279

No. 4	234,660	234,660
Total	1,260,965	1,260,965
Gear		
Crane 1:	Vessels 1&2 : SWL 45 mt x 32 m at 28 m outreach	
	Vessels 3,4,5,6 : SWL 60 mt x 32 m at 28 m outreach	
Crane 2 :	SWL 120 mt x 32 m at 28 m outreach	
Crane 3 :	SWL 120 mt x 32 m at 28 m outreach	
	Combinable SWL 240 mt	
2 Haeggblunds/Sweden hydr fast cranes combineable		
Admissible load		Container Stackweight teulfu
Tanktop	20.0mt/sqm	100/120
Tweendeck	3.2mt/sqm	40/40
Weatherdeck hatchcovers	3.0mt/sqm	70/90
		(hold no 1: 60/90)
Machinery		Main engine
Type	MAN B&W 6S40ME-B, fixed pitch propeller	In compliance with latest environmental regulations
Power	6,810KW/146 RPM	
Grade fuel used:	IFO 380	
	Auxillary engine	
Type	Yanmar 6N18AL-EV	In compliance with latest environmental regulations
Number	3	
Power	660KW/900 rpm	
Grade fuel used	IFO 380	
Generator	600 KW, 450 V, 60 Hz	
Fuel consumption at a speed of about 16 kn at design draft (Bf 2)		
Ship at sea:	about 29 mt IFO 380	
	about 2.0 mt IFO 380	
Ship in port:	about: 2.0 mt (idle)	
	about 4.0 mt (all cranes working)	
Boiler fuel consumption	about 0.7 mt IFO in port	
Navigation and communication equipment		
- 2 Arpa radars	- full GMDSS fitted	
- SATCOM Fleet Broadband 500 + C	- Navtex Receiver	
- gyro compass/autopilot	- fax	
- MF/HF transmitter/receiver	- Doppler log	
- VHF radiotelephones	- navigational echosouder	
- 3 portable VHF	with digital depthsouder	
- GPS Receiver	- ECDIS & Integrated Navigation System	
- DGPS Receiver		
- watchkeeping receiver		
- chart receiver		
All details to be considered as about, given in good faith but without any guarantee.		

Email: mail@intership-cyprus.com

Phone: +357 25 584000

Fax: +357 25 585756